

SOHO PARC *Figueres*

“Live in the best area of Figueres”



SOHO PARC Figueres consists of 2 buildings, one with views over the Parc Bosc and the other next to Plaça del Sol.

Homes with 2, 3 and 4 bedrooms, with parking in the same building. All of the distributions have been designed to provide comfort and convenience. Spaces with double height, large solarium-terraces, top-quality materials, brick-faced inside walls, ... a set of very special architectonic elements that make of SOHO PARC Figueres a development in which the aesthetics and comfort provide outstanding value.

High-quality innovative homes for those who want to live right in the heart of the town, with the guarantee and experience of Grupo Alze, promoters of the well-known TorreMirona Golf Resort.

Surroundings – *The best area in Figueres, by the Parc Bosc.*

All the comfort that only a new and modern building can offer; a very special location in Plaça del Sol, with outstanding views over the Parc Bosc and with all of the services nearby: transports, court, cultural and leisure facilities, and at just 5 minutes from the commercial area and close to the planned station of the fast train (AVE).

Communications: As a result of its geographical location, Figueres has become an important communications link:

- AP7 motorway (Barcelona – France), the national roads (N-II) and the N-260, coming from Portbou and connecting Figueres with Besalú and Olot.
- In addition, there is a main station in the centre of the town where all trains of the international line Barcelona – Portbou/Cervera stop and the direct connection with Madrid the rest of the country.
- It is necessary not to forget that in addition to the conventional train, the fast train (AVE) will be in-town in a near future.



TYPES OF PROPERTIES

Different types of homes, to fit every way of life and with parking in the same building.

- Flats with 2 and 3 bedrooms
- Lofts on the ground floor, with 2 and 4 bedrooms
- Attics with solarium-terrace.
- Attic-duplex with large terraces.



EXAMPLES OF THE DIFFERENT TYPES

2 bedrooms and 1 bathroom



3 bedrooms and 2 bathrooms



- Loft on the ground floor, with 2 bedrooms



Attic with solarium-terrace

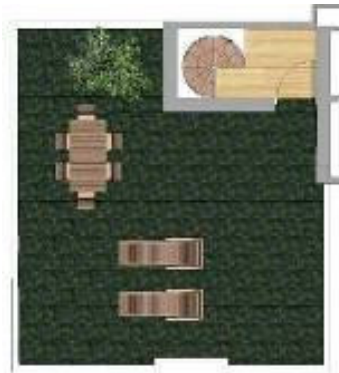

Attics – duplex, with 2 bedrooms



MEMORY OF QUALITIES

- Building of modern design. Brick-built façade, aluminium finishing ...
- Double glazing with air chamber
- Reinforced access door
- Built-in wardrobes
- Fully-furnished and equipped kitchen, including ceramic hob, oven and microwave, and extractor-hood.
- Central heating and air conditioning pre-installation
- Solar panels for sanitary hot water
- Video-intercom (connecting main entrance with flat)
- Parking basement with direct access to both buildings.





Grupo Alze is a group of companies involved on a daily basis in developing and managing projects that allow people to enjoy their life and the surrounding environment.

We build houses, golf resorts and hotel complexes which are designed to suit modern lifestyles. For more than 35 years we have endeavoured to create products that stand out for the top quality of materials used, their careful design and their situation, which integrates each product into the natural surroundings.

Information - GRUPO ALZE:

TorreMirona Golf & Spa Resort

Ctra. N- 260 – 17744 Navata

Tel. 0034 972 55 35 73

www.grupoalze.com

Financed by:

BBVA

All the illustrations are designed to give an accurate picture of the final project, though may be modified for technical or executive requirements.